



Lynfjord Travel TREK 25

GB: Manual

DE: Anleitung

FR: Manuel d'utilisation

NL: Aanwijzingen



Backpack function | Rucksackfunktion | Fonction sac à dos | Rugzak functie



Cross bag function | Cross-Bag Funktion | Fonction cross-bag | Cross-Bag functie

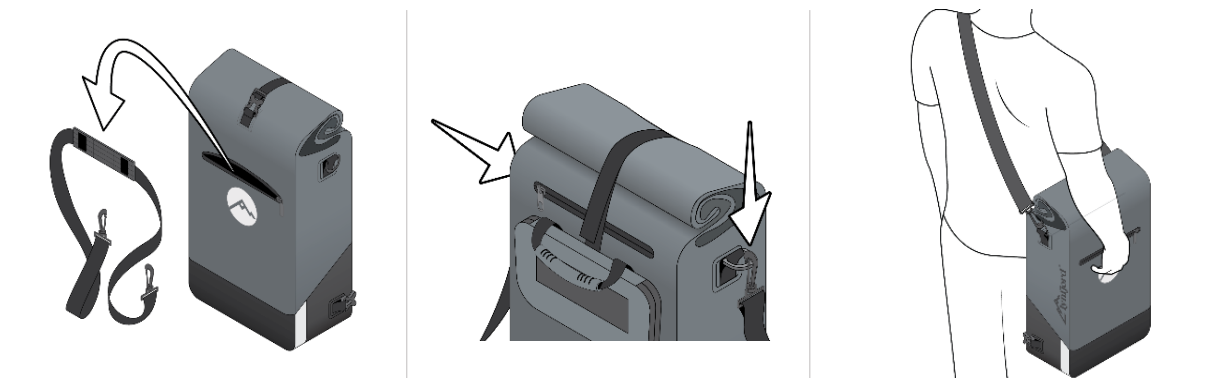

Roll closure | Rollverschluss | Fermeture à enroulement | Rolsluitin

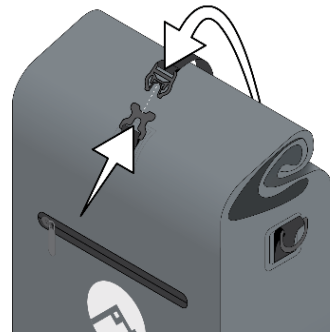
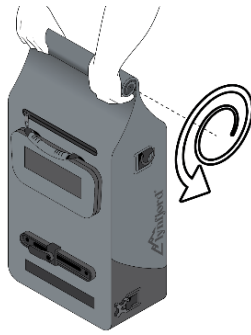
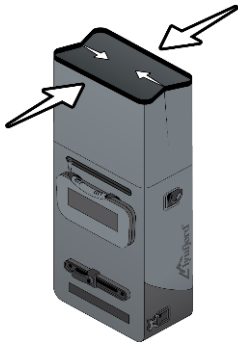

Roll Multi-Organizer

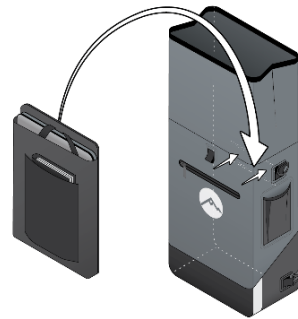
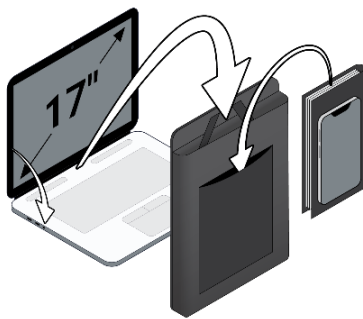
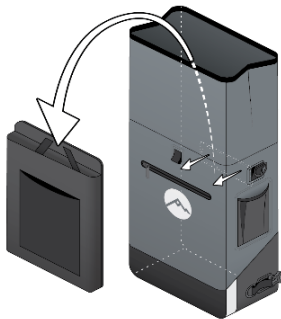

Insert bottom plate | Bodenplatte einlegen | Poser la plaque de fond | Basisplaat invoegen

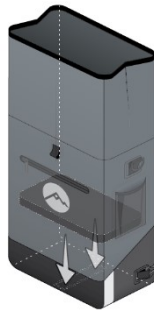
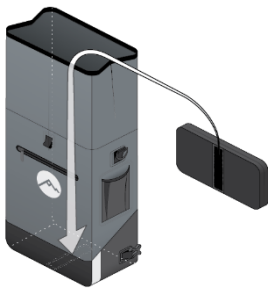

Helmet net | Helmnetz | Filet casque | Helmnet

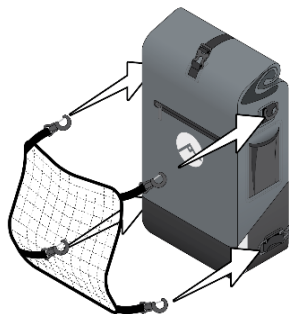
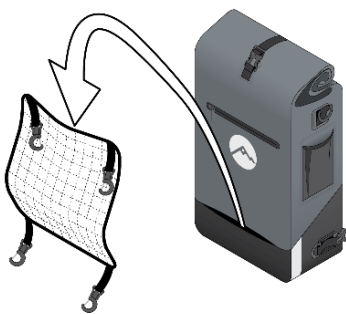

Upper/Oberes/Supérieure/Bovenste 3-Point-Quick-Clip system

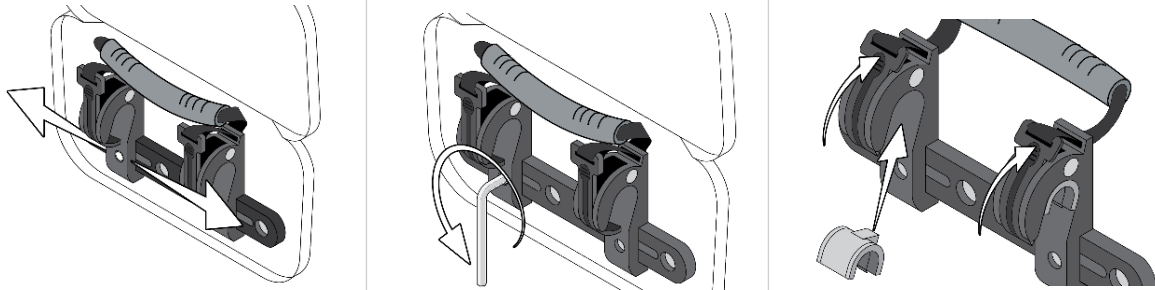

Lower/Unteres/Inférieur/Onderste 3-Point-Quick-Clip system

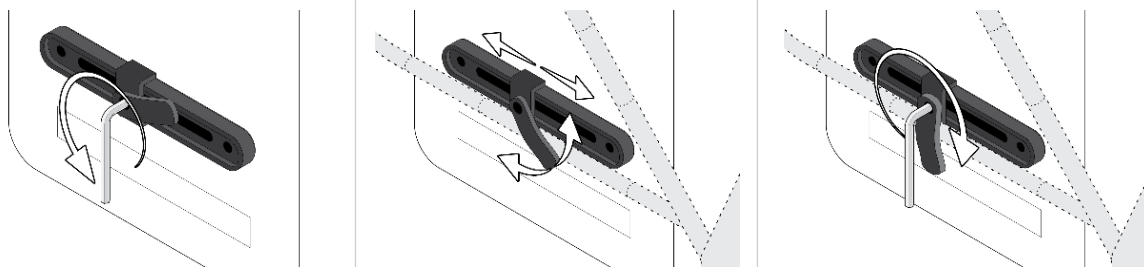

Attach to luggage carrier | Anbringung am Gepäckträger | Fixer le porte-bagages | Bevestig tas bagagedrager

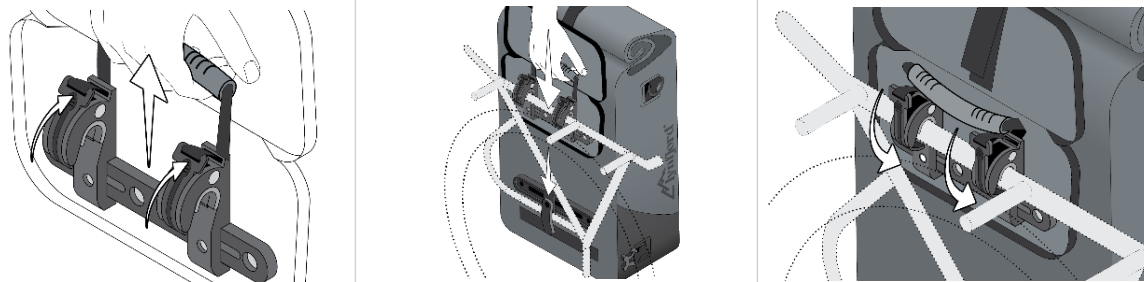

Remove from luggage carrier | Abnahme vom Gepäckträger | Retirer du porte-bagages | Haal uit de bagagedrager

